





LEGEND:

-  FIRE EXTINGUISHER
-  FIRE HOSE
-  WET/DRY STAND PIPE
-  FIRE LANE

STAGE 3

127'-0" X 105'-0"
13,335 SQ. FT.
GRID HEIGHT = 35'-0"
(SLAB ON GRADE)

INTERCONNECTING DOOR OPEN TO MAX. 83'-0" WIDE

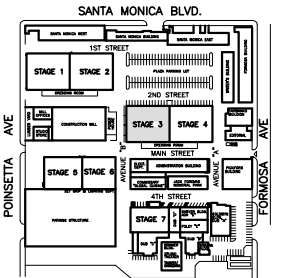

STAGE 3

SCALE 1/16"=1'-0"

 **THE LOT**
1041 North Formosa Avenue
West Hollywood California
90046
T (323) 850-3184 F (323) 850-3190

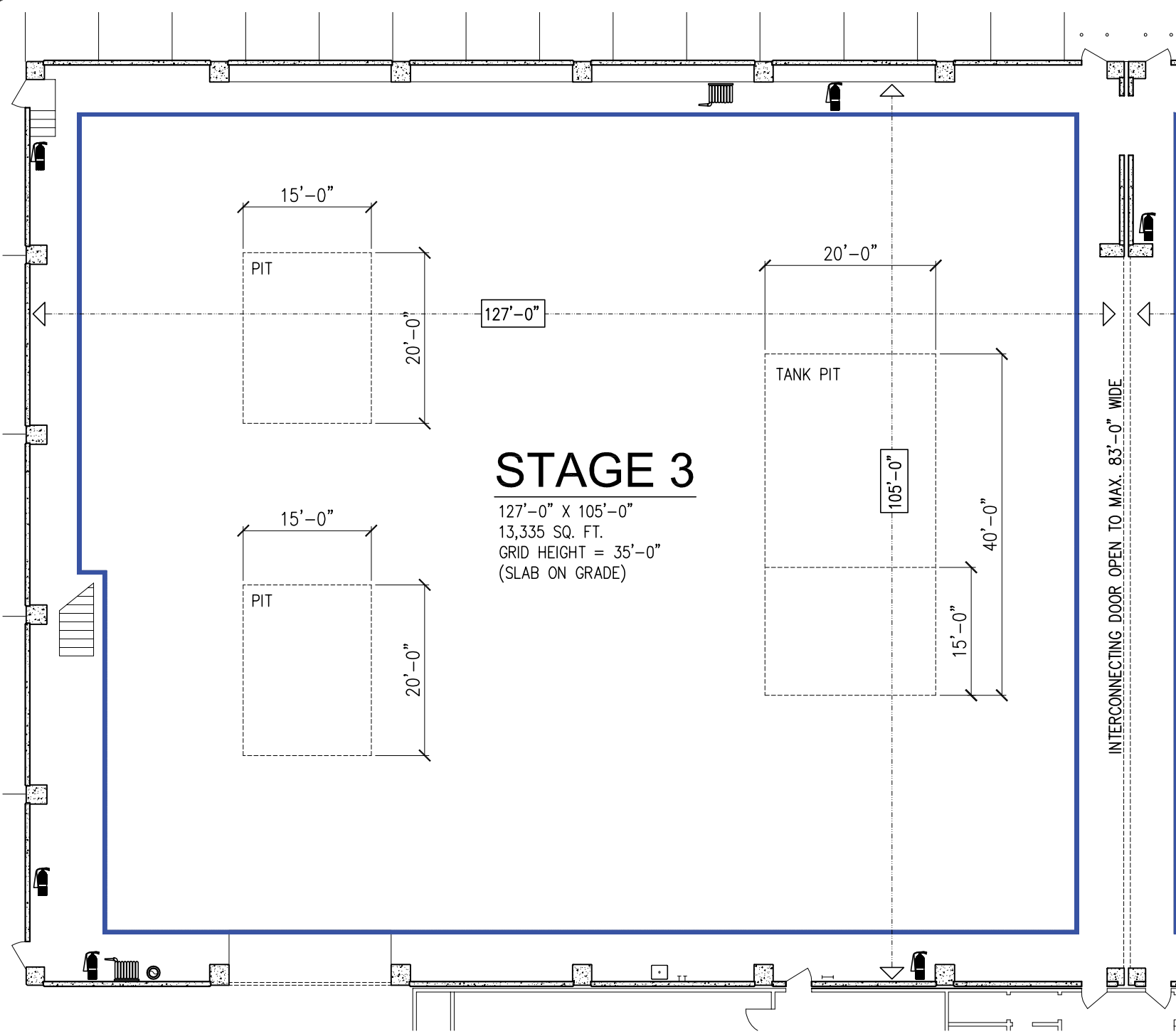

Stage 3: Specifications



Stage Specifications (Dimensions Include 4' Fire Lane)

Width: 127'

Length: 105'

Height (to Perms): 35'

Total Square Footage: 13,335 sf

Floor Type: Wood over concrete slab

Interconnecting Equipment Door (H X W): 9' 10" X 6' 10"

Interconnecting Removable Modular Walls (H X W): 34' 6" x 83' (Advance notice and additional charges apply to remove)

Elephant Door (H X W): 19' 8" X 18' 7"

Support Space

Six (6), 13' X 9', attached dressing rooms located upstairs

One (1), 18' 6" X 20' 9", ante room with air conditioning; interior access only

Electric Services

Build / Wrap Power: 600 amps

Pre-light / Shoot Power: 4,800 amps

Power in Grid: No

HVAC

30 Ton Cooling Only Package Unit

Redlight Control: Available

Ventilation: Yes

Heating: Available

Stage Extras

Water Hose Bib: Yes

Natural Gas: Yes

Slop Sink: Yes

Compressed Air: Yes

Wireless Internet: Available

Phone: Available

Fax: Available